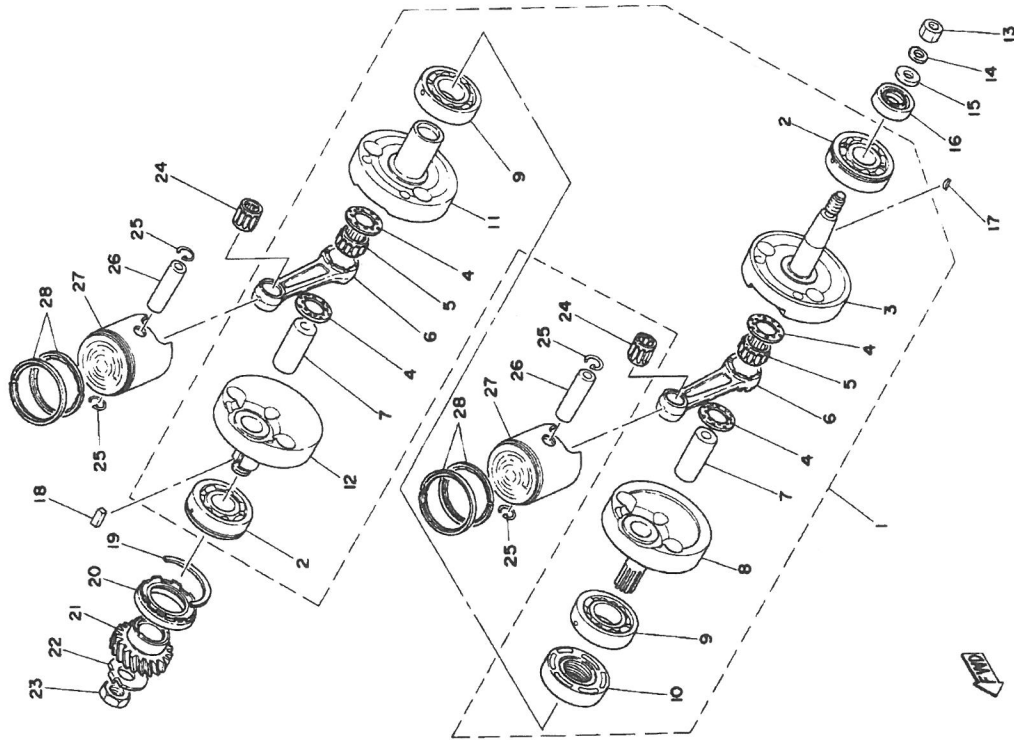



Fig. 4 CRANK - PISTON (2)



Ref.No.	Parts No.	Description	Q'ty 250	Q'ty 400	Applicable Machine No.	Remarks
4-22	90215-18131	WASHER, lock	1	1		
4-23	90170-16182	NUT	1	1		
4-24	93310-216A3	BEARING, con-rod small end	1			
	93310-216E1	BEARING, con-rod small end	1			
4-25	93450-170250	CIRCLIP (137-11634-00)	4	4		
4-26	280-11633-00	PIN, piston	2			
	278-11633-00	PIN, piston	2			
4-27	2R8-11631-00-96	PISTON (53.96mm STD)	UR			
	2R8-11631-00-98	PISTON (53.98mm STD)	2			
	2R8-11635-00	PISTON (54.25mm 1st O.S.)	2			Alternate Parts
	2R8-11636-00	PISTON (54.50mm 2nd O.S.)	2			Alternate Parts
	2R8-11637-00	PISTON (54.75mm 3rd O.S.)	2			Alternate Parts
	2R8-11638-00	PISTON (55.00mm 4th O.S.)	2			Alternate Parts
	2R9-11631-00-96	PISTON (63.96mm STD)	UR			
	2R9-11631-00-98	PISTON (63.98mm STD)	2			
	2R9-11635-00	PISTON (64.25mm 1st O.S.)	2			Alternate Parts
	2R9-11636-00	PISTON (64.50mm 2nd O.S.)	2			Alternate Parts
	2R9-11637-00	PISTON (64.75mm 3rd O.S.)	2			Alternate Parts
	2R9-11638-00	PISTON (65.00mm 4th O.S.)	2			Alternate Parts
4-28	2R8-11610-00	PISTON RING SET (STD)	2s			
	2R8-11610-10	PISTON RING SET (1st O.S.)	2s			Alternate Parts
	2R8-11610-20	PISTON RING SET (2nd O.S.)	2s			Alternate Parts
	2R8-11610-30	PISTON RING SET (3rd O.S.)	2s			Alternate Parts
	2R8-11610-40	PISTON RING SET (4th O.S.)	2s			Alternate Parts
	1A1-11610-00	PISTON RING SET (STD)	2s			
	1A1-11610-10	PISTON RING SET (1st O.S.)	2s			Alternate Parts
	1A1-11610-20	PISTON RING SET (2nd O.S.)	2s			Alternate Parts
	1A1-11610-30	PISTON RING SET (3rd O.S.)	2s			Alternate Parts
	1A1-11610-40	PISTON RING SET (4th O.S.)	2s			Alternate Parts



Fig. 44 REPAIR KIT (1)

Ref.No.	Parts No.	Description	Q'ty 250 400	Applicable Machine No.	Remarks
44-1	2R8-11630-00	. PISTON ASS'Y (STD)	2s		
	2R8-11630-10	. PISTON ASS'Y (1st O.S.)	2s		
	2R8-11630-20	. PISTON ASS'Y (2nd O.S.)	2s		
	2R8-11630-30	. PISTON ASS'Y (3rd O.S.)	2s		
	2R8-11630-40	. PISTON ASS'Y (4th O.S.)	2s		
	2R9-11630-00	. PISTON ASS'Y (STD)	2s		
	2R9-11630-10	. PISTON ASS'Y (1st O.S.)	2s		
	2R9-11630-20	. PISTON ASS'Y (2nd O.S.)	2s		
	2R9-11630-30	. PISTON ASS'Y (3rd O.S.)	2s		
	2R9-11630-40	. PISTON ASS'Y (4th O.S.)	2s		
44-2	93450-17025	. CIRCLIP (137-11634-00)	4		Ref.No. 4-25
44-3	280-11633-00	. PIN, piston	2		Ref.No. 4-26
	278-11633-00	. PIN, piston	2		Ref.No. 4-26
44-4	1A0-11631-00-96	. PISTON (STD)	UR		
	1A0-11631-00-98	. PISTON (STD)	2		
	1A0-11635-00	. PISTON (1st O.S.)	2		
	1A0-11636-00	. PISTON (2nd O.S.)	2		
	1A0-11637-00	. PISTON (3rd O.S.)	2		
	1A0-11638-00	. PISTON (4th O.S.)	2		
	1A1-11631-00-96	. PISTON (STD)	UR		Ref.No. 4-14
	1A1-11631-00-98	. PISTON (STD)	2		
	1A1-11635-00	. PISTON (1st O.S.)	2		
	1A1-11636-00	. PISTON (2nd O.S.)	2		
	1A1-11637-00	. PISTON (3rd O.S.)	2		
	1A1-11638-00	. PISTON (4th O.S.)	2		

Ref.No.	Parts No.	Description	Q'ty 250 400	Applicable Machine No.	Remarks
44-5	2R8-11610-00	. PISTON RING SET (STD)	2s		
	2R8-11610-10	. PISTON RING SET (1st O.S.)	2s		
	2R8-11610-20	. PISTON RING SET (2nd O.S.)	2s		
	2R8-11610-30	. PISTON RING SET (3rd O.S.)	2s		
	2R8-11610-40	. PISTON RING SET (4th O.S.)	2s		Ref.No. 4-28
	1A1-11610-00	. PISTON RING SET (STD)	2s		
	1A1-11610-10	. PISTON RING SET (1st O.S.)	2s		
	1A1-11610-20	. PISTON RING SET (2nd O.S.)	2s		
	1A1-11610-30	. PISTON RING SET (3rd O.S.)	2s		
	1A1-11610-40	. PISTON RING SET (4th O.S.)	2s		
44-6	2R8-11650-00	CONNECTING ROD ASS'Y	2s		
	2R9-11650-00	CONNECTING ROD ASS'Y	2s		
44-7	90209-22071	. WASHER (164-11685-00)	4		Ref.No. 4-4
44-8	93310-42231	. BEARING, con-rod big end	2		Ref.No. 4-5
44-9	2R8-11651-00	. ROD, connecting	2		Ref.No. 4-6
	2R9-11651-00	. ROD, connecting	2		Ref.No. 4-6
44-10	2R8-11681-00	. PIN, crank	2		Ref.No. 4-7
	2R9-11681-00	. PIN, crank	2		Ref.No. 4-7
44-11	93310-216A3	. BEARING, con-rod small end	2		Ref.No. 4-24
	93310-216E1	. BEARING, con-rod small end	2		Ref.No. 4-24
44-12	2R8-W0001-00	GASKET KIT	1s		
	2R9-W0001-00	GASKET KIT	1s		
44-13	1A0-11181-01	. GASKET, cylinder head	2		Ref.No. 1-2
	1A2-11181-00	. GASKET, cylinder head	2		Ref.No. 1-2
44-14	278-11351-01	. GASKET, cylinder	2		Ref.No. 1-5
44-15	137-15353-00	. GASKET, drain plug	1		Ref.No. 2-16
44-16	93210-11073	. O-RING	4		Ref.No. 2-25
44-17	1A0-15461-00	. GASKET, crankcase cover right	1		Ref.No. 3-14
44-18	93210-27194	. O-RING (2.5-27)	1		Ref.No. 3-20